

C-ECblue

for direct current, 110 V

RH25C-6IK



Description

Motor technology: EC
 Rated voltage U_N : **DC110 V***
 Input power P_{sys} : **480 W***
 Rated current I_N : **4.40 A***
 Rated speed n_N : **3120 min⁻¹***
 Thermal class: **THCL155***
 Min. permitted ambient temperature t_{R-} : -35 °C
 Max. permitted ambient temperature t_{R+} at n_{max} : 50 °C
 Electrical connection: Integrated controller
 Balancing quality: G 6.3
 Degree of protection : IP54
 Motor protection: Integrated active temperature management
 Impeller : aluminium, uncoated
 Conformity: CE
 *Rated data

Characteristic curve

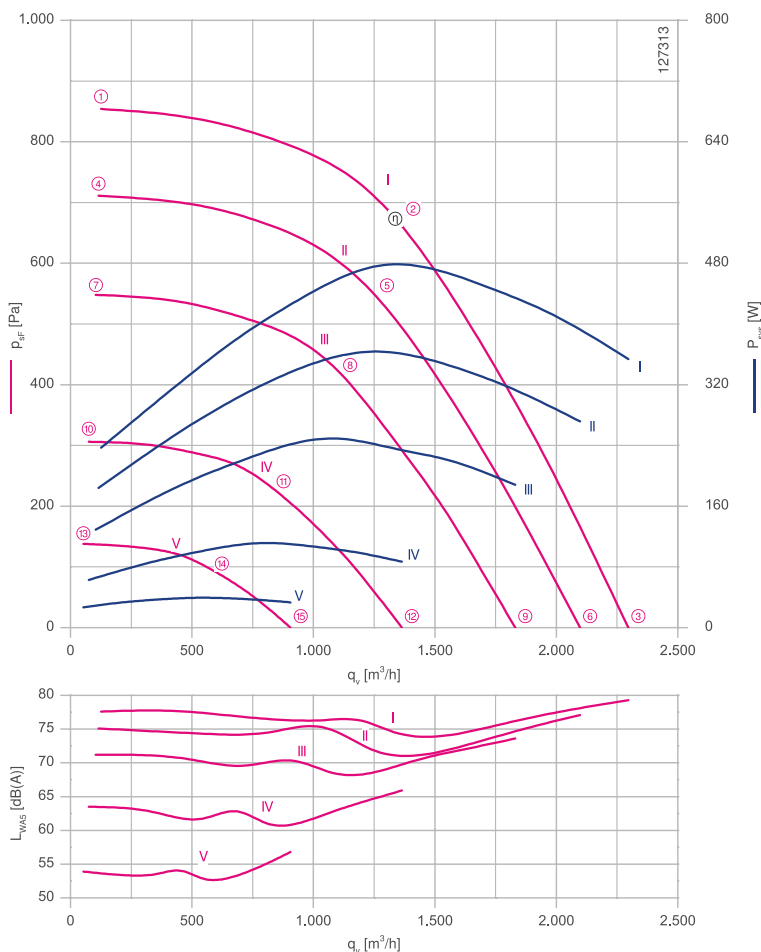

Measured with inlet ring, without guard grille according to ISO 5801

Inlet ring	00401777	RAL 7032 (pebble grey)	Page 302
Inlet ring	00400803	unpainted	
Connection diagram	1360-384		Page 326

Dimensions mm

Free-running motorized impeller RH
in installation position H/Vu/Vo

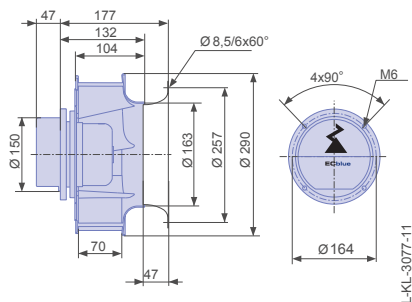

Performance data

Type	Characteristic curve	Speed	Operating point	Current	Input power	Suction side sound power level	Maximum ambient temperature
		n min ⁻¹		I A	P _{sys} W	L _{WAS} dB(A)	t _R °C
RH25C-6IK.BA.1R	I	3130	①	2.10	240	78	
		3120*	②	4.40*	480	75	50
		3120	③	3.20	350	79	
	II	2850	④	1.65	180	75	
			⑤	3.30	360	72	60
			⑥	2.50	270	77	
	III	2500	⑦	1.15	130	71	
			⑧	2.30	250	68	60
			⑨	1.70	190	74	
	IV	1870	⑩	0.56	65	64	
			⑪	1.00	110	61	60
			⑫	0.78	85	66	
	V	1250	⑬	0.24	26	54	
			⑭	0.35	40	53	60
			⑮	0.30	34	57	

*rated data

Fan ordering information

Design RH*

Installation position H/Vu/Vo



Type RH25C-6IK.BA.1R

Article no. 174661

Weight kg 7.00

* inlet ring not included

Control technology

Operating terminal



Page 316