

Tangential blowers

QLN 65 double housing with EC motor

Tangential blowers with electronically commutated EC-motors.

- integrated electronics
- speed setting via 0 - 10 V analogue voltage signal
- speed-adjustable (version) via PWM signal available upon request
- impeller diameter 65 mm
- horizontal or vertical mounting position
- protection class IP20, insulation class F
- permissible ambient temperature 0 – 60 °C



ebm-papst • Landshut

Nominal data	rated voltage	air flow	max. pressure increase	power input	speed	mass	Dimensions mm				
	V	m ³ /h	Pa	W	min ⁻¹	kg	a	b	c	g	h
QLN65/2424-2212	24	360	42	19	1250	1,5					

subject to alterations

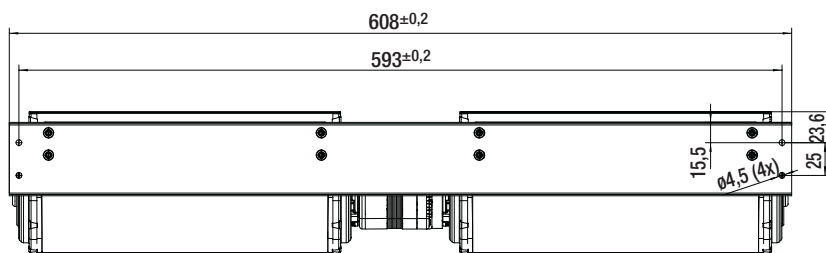

Characteristic curves

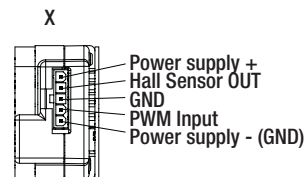
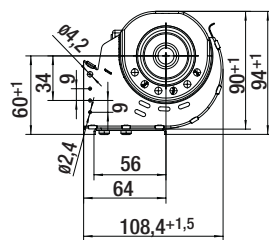
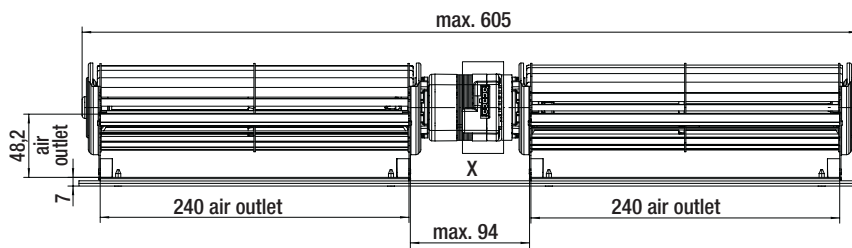
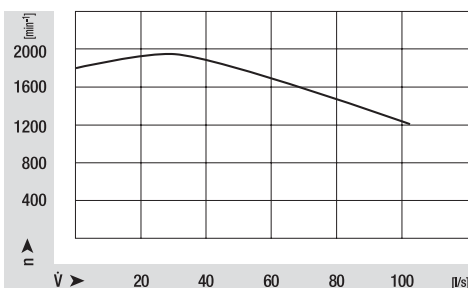
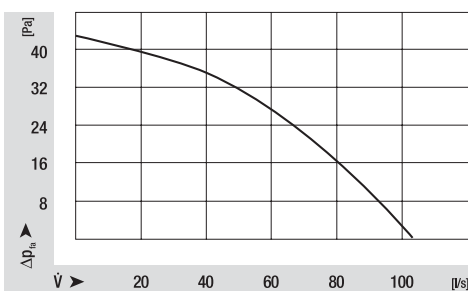

suitable for connector housing Mini-Fit, Jr. (Fa. Molex)
order number 39-01-4050