



Ghisa EN-GJL-250

Fonte EN-GJL-250

Hierro fundido EN-GJL-250

Cast Iron EN-GJL-250

Grauguss EN-GJL-250

Чугун EN-GJL-250

Curva caratteristica - Performance curve - Courbe caractéristique
Kennlinie - Curva característica - Характеристическая кривая

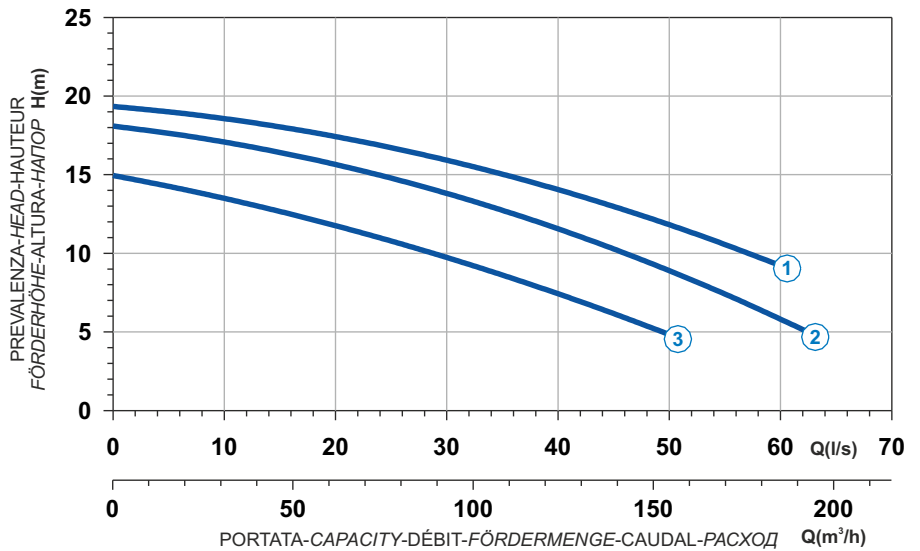

| | |
|-------------------|-------------------|
| Power supply | 3ph 400/690V 50Hz |
| R.P.M. | 1450 |
| Free passage (mm) | 80 |
| Discharge (mm) | DN 100 |
| Max Weight (Kg) | 205 |

| Curve N° | Code | Type | MOTOR | | | ATEX code |
|----------|---------|-----------------|---------------------|---------------------|-------------------------|-----------|
| | | | Rated power P2 (kW) | Rated current I (A) | Starting current Is (A) | |
| 1 | 7000189 | G413R6V1-P80AA2 | 16 | 29,7 | 175 | 7007474 |
| 2 | 7001145 | G413R6V2-P80AA2 | 12,9 | 24,1 | 142 | 7007390 |
| 3 | 7001166 | G413R6V3-P80AA2 | 10 | 19 | 112 | 7007487 |

Dimensioni - Dimensions - Dimensions - Abmessungen - Dimensiones - Габариты (mm)

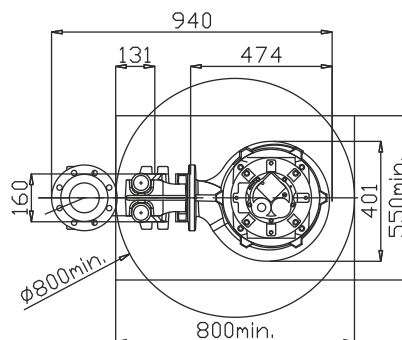
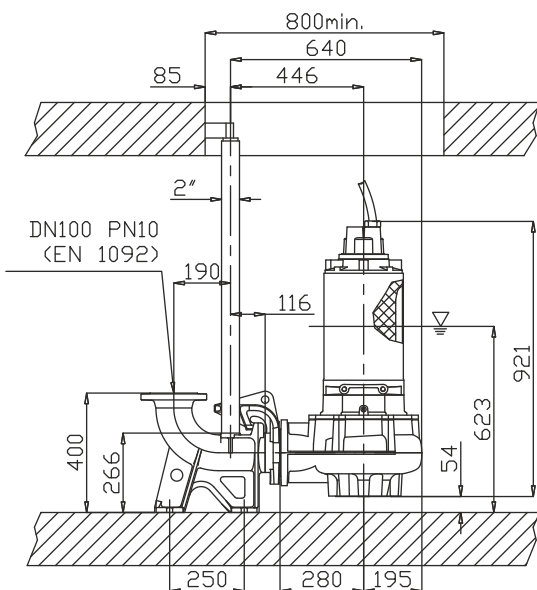

▽ LIVELLO MINIMO DI SOMMERSIBILITÀ
MINIMUM SUBMERSIBLE LEVEL
NIVEAU MINIMUM D'IMMERSION
MINDESTWASSERSTAND
NIVEL SUMERGIBLE MÍNIMO
МИНИМАЛЬНАЯ ГЛУБИНА ПОГРУЖЕНИЯ

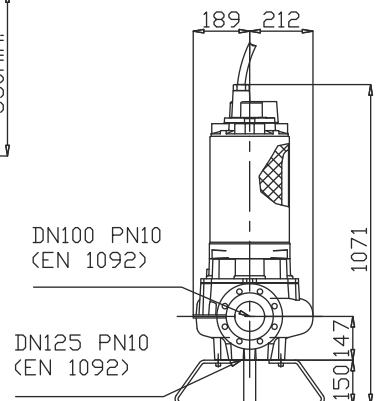

Versione disponibile con mantello di raffreddamento - Type available also with cooling jacket
Version disponible avec chemise de refroidissement - Ausführung auch mit Kühlmantel lieferbar
Disponible también con camisa de refrigeración - Вариант доступен с рубашкой охлаждения