

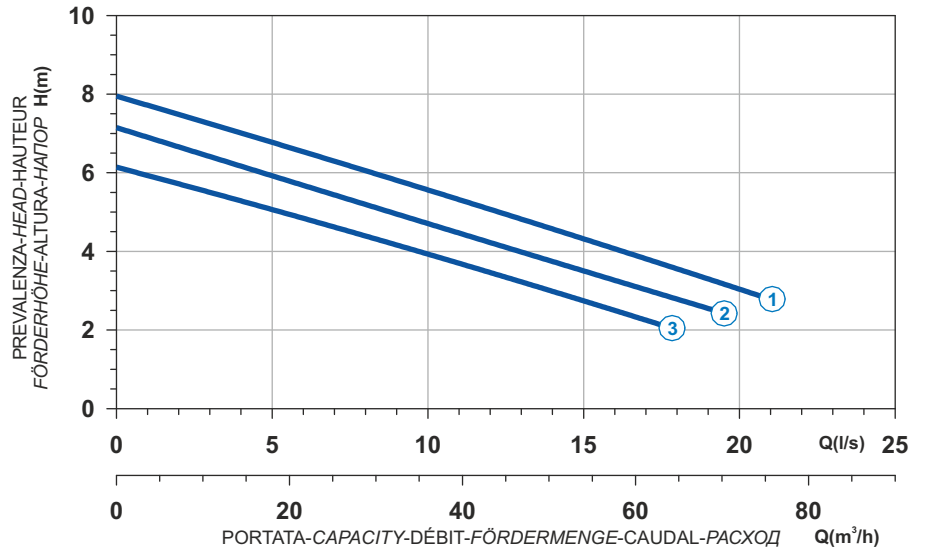

- Ghisa EN-GJL-250
- Fonte EN-GJL-250
- Hierro fundido EN-GJL-250

- Cast Iron EN-GJL-250
- Grauguss EN-GJL-250
- Чугун EN-GJL-250

Curva caratteristica - Performance curve - Courbe caractéristique
Kennlinie - Curva característica - Характеристическая кривая



Power supply	3ph 400V 50Hz
R.P.M.	1450
Free passage (mm)	40
Discharge (mm)	DN 80
Max Weight (Kg)	49

Curve N°	Code	Type	MOTOR			ATEX code
			Rated power P2 (kW)	Rated current I (A)	Starting current Is (A)	
1	7004759	G471T2H1-M40AA0	1,6	3,1	13,9	7008507
2	7001513	G471T2H2-M40AA0	1,6	3,1	13,9	7003119
3	7001865	G471T2H3-M40AA0	1,4	2,7	12,1	7008406

Dimensioni - Dimensions - Dimensions - Abmessungen - Dimensiones - Габариты (mm)

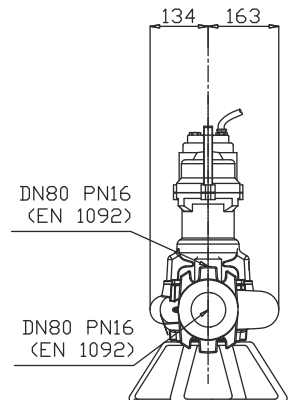
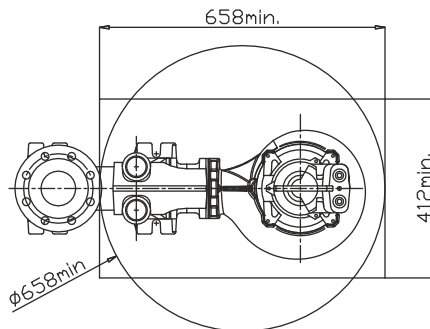
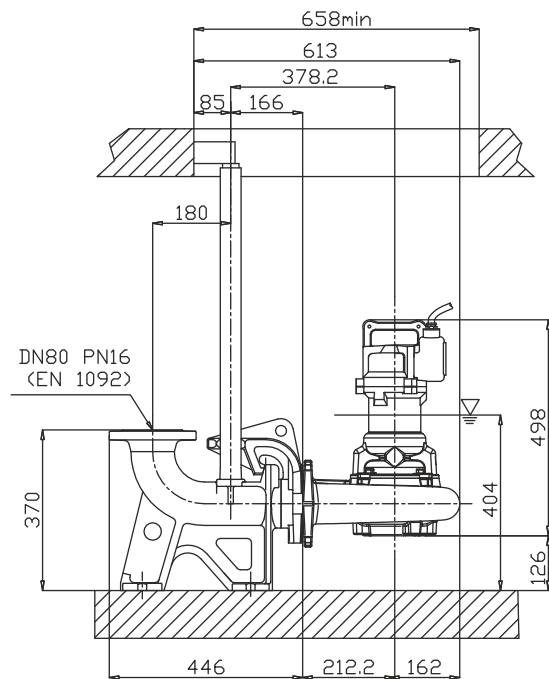

▽ LIVELLO MINIMO DI SOMMERGIBILITÀ
MINIMUM SUBMERSIBLE LEVEL
NIVEAU MINIMUM D'IMMERSION
MINDESTWASSERSTAND
NIVEL SUMERGIBLE MÍNIMO
МИНИМАЛЬНАЯ ГЛУБИНА ПОГРУЖЕНИЯ