

8,10,12 HP: AJH072LELBH / AJH090LELBH / AJH108LELBH
14,16,18 HP: AJH126LELBH / AJH144LELBH / AJH162LELBH



Specifications

| Rating Capacity range | | HP | 8 | 10 | 12 | 14 | 16 | 18 |
|------------------------------------|---------------------------------|--------------------------|-----------------------------------|---------------|---------------|---------------|---------------|---------------|
| Model name | | | AJH072LELBH | AJH090LELBH | AJH108LELBH | AJH126LELBH | AJH144LELBH | AJH162LELBH |
| Maximum Connectable Indoor Unit | | | 1-20 | 1-25 | 1-30 | 1-36 | 1-40 | 1-42 |
| Power source | | | 3 phase, ~400V, 50Hz | | | | | |
| Capacity | Cooling | kW | 22.4 | 28.0 | 33.5 | 40.0 | 45.0 | 50.0 |
| | Nominal Heating | | 22.4 | 28.0 | 33.5 | 40.0 | 45.0 | 50.0 |
| | Max Heating | | 25.0 | 31.5 | 37.5 | 45.0 | 50.0 | 55.0 |
| Input power | Cooling | kW | 6.30 | 8.59 | 10.42 | 12.12 | 14.96 | 18.52 |
| | Nominal Heating | | 4.65 | 6.61 | 8.18 | 9.71 | 11.81 | 13.66 |
| | Max Heating | | 5.45 | 8.29 | 10.25 | 11.80 | 14.29 | 16.66 |
| EER | Cooling | | 3.56 | 3.26 | 3.22 | 3.30 | 3.01 | 2.70 |
| COP | Nominal Heating | W/W | 4.82 | 4.24 | 4.10 | 4.12 | 3.81 | 3.66 |
| | Max Heating | | 4.56 | 3.80 | 3.66 | 3.81 | 3.50 | 3.30 |
| Airflow rate | | m ³ /h | 8,400 | 9,000 | 11,000/12,100 | 13,000 | 14,000 | 14,800/15,300 |
| Sound pressure level / Power level | Cooling | dB(A) | 52/66 | 54/69 | 59/73 | 62/75 | 64/77 | 65/79 |
| | Heating | | 54/— | 57/— | 62/— | 63/— | 65/— | 68/— |
| Net Dimensions | Height | mm | 1,428 | 1,428 | 1,428 | 1,638 | 1,638 | 1,638 |
| | Width | | 1,080 | 1,080 | 1,080 | 1,080 | 1,080 | 1,080 |
| | Depth | | 480 | 480 | 480 | 480 | 480 | 480 |
| Weight | | kg | 170 | 177 | 178 | 213 | 213 | 217 |
| Refrigerant | Type (Global Warming Potential) | | R410A (2,088) | R410A (2,088) | R410A (2,088) | R410A (2,088) | R410A (2,088) | R410A (2,088) |
| | Charge | kg(CO ₂ eq-T) | 7.0 (14.6) | 7.5 (15.7) | 7.5 (15.7) | 11.0 (22.9) | 11.0 (22.9) | 11.8 (24.6) |
| Connection pipe diameter | Liquid | mm | 9.52 | 9.52 | 12.70 | 12.70 | 12.70 | 12.70 |
| | Gas | | 19.05 | 22.20 | 28.58 | 28.58 | 28.58 | 28.58 |
| Total pipe length | | m | 400 | 400 | 400 | 400 | 400 | 400 |
| Max. height difference | | | 50/40 (Outdoor unit: Upper/Lower) | | | | | |
| Operation range | Cooling | °C | -15 to 46 | -15 to 46 | -15 to 46 | -5 to 46* | -5 to 46* | -5 to 46* |
| | Heating | | -20 to 21 | -20 to 21 | -20 to 21 | -20 to 21 | -20 to 21 | -20 to 21 |

Note: Specifications are based on the following conditions.

Cooling: Indoor temperature of 27°CDB / 19°CWB, and outdoor temperature of 35°CDB / 24°CWB.

Heating: Indoor temperature of 20°CDB / (15°CWB), and outdoor temperature of 7°CDB / 6°CWB.

Pipe length: 7.5 m; Height difference between outdoor unit and indoor unit: 0 m.

* The cooling operation range of -15 to 46°C is allowed only when all of the indoor units connected to the system are higher than capacity of 5.6kW.

Dimensions

(Unit : mm)

8, 10, 12 HP

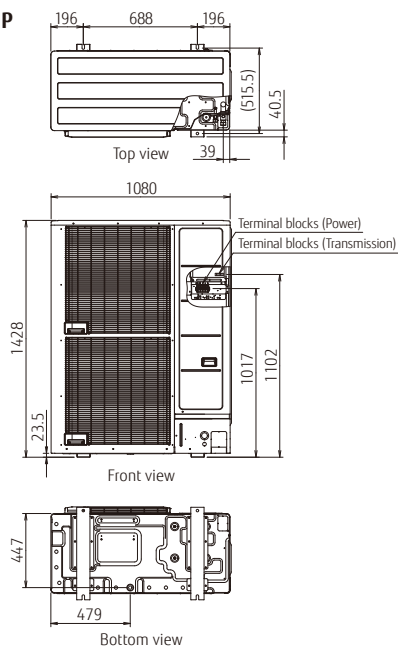

14, 16, 18 HP

